

4x HEB320x6940 1019
1:10 S235JR

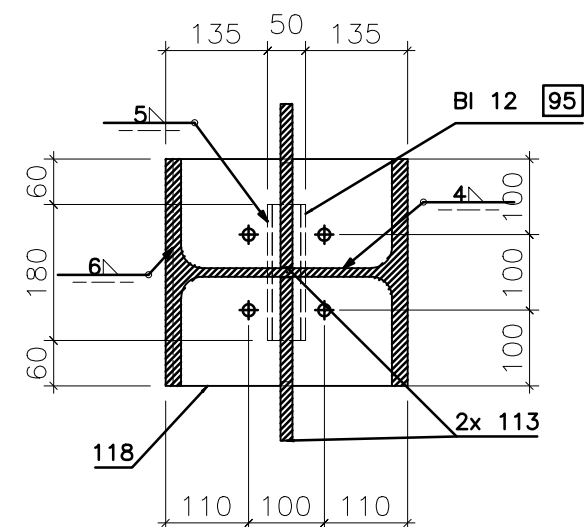
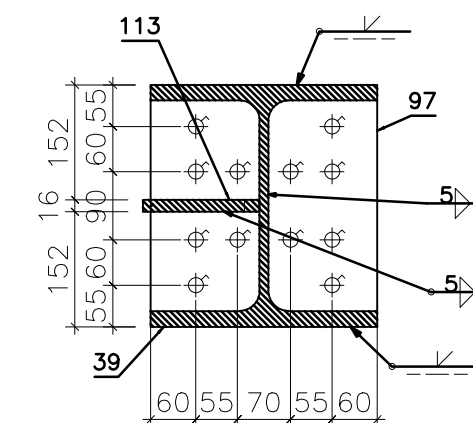
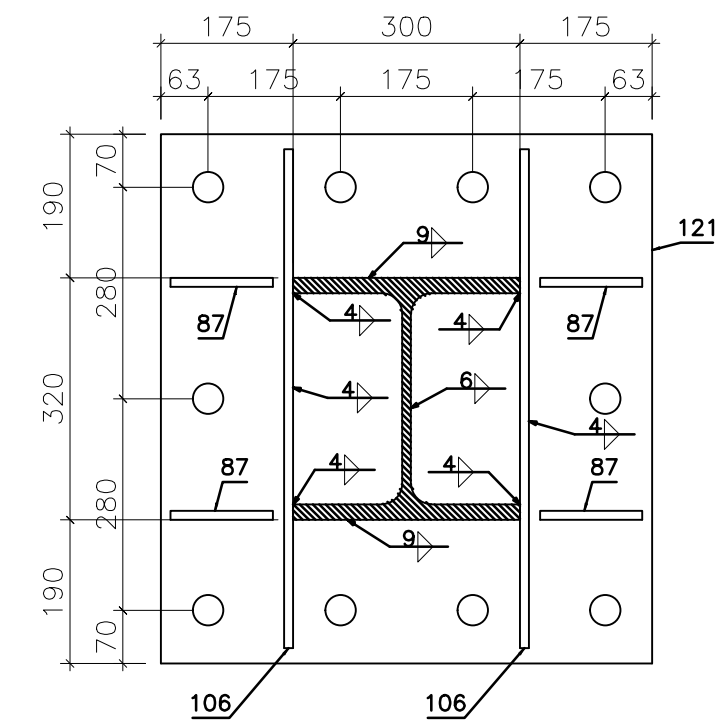

Technical drawing of a cross-section of a reinforced concrete column. The drawing shows the reinforcement layout, including longitudinal bars (118 mm diameter) and transverse bars (2x 113 mm diameter). The reinforcement is arranged in a grid pattern. The drawing includes dimensions for the column size, reinforcement spacing, and bar diameters. A table in the top right corner provides additional information: 'BI 12' and '95'.

| Pozycja | Nazwa | Ilość (szt.) | Długość (mm) | Szerokość (mm) | Materiał | Waga (kg) | Powłoka |
|---------|--------------|--------------|--------------|----------------|----------|-----------|---------|
| 1019 | HEB320 | 4 | | | | | |
| 48 | HEB320 | 1 | 6940 | 0 | S235JR | 881.38 | 12.28 |
| 87 | BL12x250x150 | 4 | 250 | 150 | S235JR | 2.67 | 0.07 |
| 106 | BL12x660x250 | 2 | 660 | 250 | S235JR | 13.42 | 0.3 |
| 121 | BL25x700x650 | 1 | 700 | 650 | S235JR | 89.29 | 0.98 |
| 95 | BL12x180x50 | 1 | 180 | 50 | S235JR | 0.85 | 0.02 |
| 118 | BL16x310x300 | 1 | 310 | 300 | S235JR | 11.68 | 0.21 |
| 110 | BL16x277x143 | 2 | 277 | 143 | S235JR | 4.92 | 0.09 |
| 113 | BL16x298x224 | 2 | 298 | 224 | S235JR | 7.55 | 0.14 |
| 39 | HEB320 | 2 | 299 | 0 | S235JR | 37.97 | 0.53 |
| 97 | BL25x320x300 | 2 | 320 | 300 | S235JR | 18.84 | 0.22 |
| 100 | BL25x300x290 | 2 | 300 | 290 | S235JR | 17.07 | 0.2 |
| Razem: | | 20 | | | | 1085.66 | 15.04 |